

Fuses + Fuse Holders

Prices see shop.griederbauteile.ch

FLUKE FUSES	Page 1
5 X 15MM	Page 2
5 X 20MM	Page 2
FUSE HOLDERS (5X20 + 6X32)	Page 3
6 X 32MM	Page 4
RESETTABLE FUSES	Page 4
SUBMINIATURE FUSES + HOLDERS	Page 5
THERMAL FUSES, CUT-OFF FUSES	Page 6
THERMOSTAT, THERMAL CUT-OUT	Page 7
PHOTOVOLTACIT FUSES + HOLDER	Page 7
DIAZED FUSES	Page 7
CIRCUIT BREAKER,	Page 8
ATO/FKS BLADE FUSES + HOLDER	Page 9
BOLT-DOWN CAR FUSES	Page 10
TORPEDO CAR FUSES + HOLDER	Page 10

FLUKE Fuses

WXF.SA125F

Suitable:

Fluke 710, 712, 713, 714, 715
Fluke 716, 717, 718

WXF.SA440F

Suitable:

Fluke 175, 177, 179, 187, 189
Fluke 23-3, 26-3, 27
Fluke 45
Fluke 77-3, 787, 79-3
Fluke 83, 83-3, 83-5, 85
Fluke 85-3, 863, 865, 867
Fluke 87, 87-3, 87-4, 87-5
Fluke 89-4

WXF.S11AF

Suitable:

Fluke 111, 112, 175, 177, 179
Fluke 183, 185, 187, 189
Fluke 21-3, 23-3, 26-3, 27
Fluke 45
Fluke 73-3, 75-3, 77-3, 79-3
Fluke 83, 83-3, 83-5, 85, 85-3
Fluke 863, 865, 867
Fluke 87, 87-3, 87-4, 87-5
Fluke 89-4

WXF.S2AF

Suitable:

Roline RO-500

WXF.S1AF

Suitable:

Fluke 76, 79-2,
Fluke 83, 85, 86, 87, 88

WXF.S3AF

Suitable:

Fluke 21, 25, 27
Fluke 75, 77
Fluke 8010A, 8012A, 8020B
Fluke 8021B, 8022B, 8024B
Fluke 8025A, 8025B, 8026B
Fluke 8050A, 8060A, 8062A
Fluke 8840A, 8842A



Order no	Current	Voltage	Dimension	Make
WXF.SA125F	125mA	250V	5x15mm	Littlefuse 2AG.19x.60
WXF.SA440F	440mA	1kV	10.3x35mm	Bussmann DMM-44
WXF.SA630F	630mA	250V	5x20mm	Bussmann GDA630
WXF.S1AF	1A	600V	10.3x35mm	Bussmann BBS-1
WXF.SK2AF	2A	250V	6.3x25.4mm	Littlefuse 361002
WXF.S2AF	2A	600V	10.3x35mm	
WXF.S3AF	3A	600V	10.3x35mm	Bussmann BBS-3
WXF.S11AF	11A	1000V	10.3x35mm	Bussmann DMM-11
WXF.S15AF	15A	600V	10.3x35mm	Bussmann KTK-15
WXF.S20AF	20A	600V	10.3x38.1mm	Bussmann KTK-20

WXF.SK2AF

Suitable:

Fluke 8010A, 8012A, 8020A, 8020B
Fluke 8021B, 8022A, 8022B, 8024A,
8024B
Fluke 8026B, 8030A, 8040A, 8050A,
8060A
Fluke 8062A, 8840A, 8842A

WXF.S15AF

Suitable:

Fluke 21-2, 23, 23-2, 25, 27, 29-2
Fluke 452
Fluke 73, 73-2, 75, 75-2, 76, 77, 77-2, 78
Fluke 79-2, 83, 85, 86, 87, 88

WXF.SA630F

Suitable:

Fluke 21, 21-2, 21-3, 23,
23-2, 25, 27
Fluke 73-3, 75, 75-2, 75-3,
77, 77-2
Fluke 8025A, 8025B

WXF.S15AF

Suitable:

Fluke 23, 25, 27
Fluke 8025A, 8025B

Miniature Fuses 5 x 15mm, Quick-Acting, 250V

Order no	Current (A)
WXF.SA 125F	125m
MFR.A5	500m
MFR.1A	1
MFR.1A6	1.6
MFR.2A	2

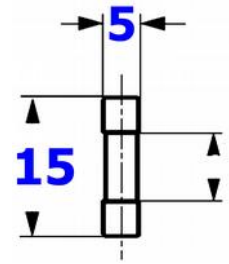

Fuse 5 x 20mm, Super-Quick-Acting (FF), 250V

Glass tube or cermaic tube

Rated voltage: 250VAC

Design: super-quick-acting (FF)

Size: 5 x 20mm

Breaking capacity: 1500A @ 250VAC (cos phi = 0.7 - 0.8)

Ambient temperature: -40°C to +85°C



Order no	Current (A)
MFE.1A6	1.6
MFE.2A	2
MFE.2A5	2.5
MFE.3A 15	3.15
MFE.4A	4
MFE.5A	5
MFE.6A3	6.3
MFE.8A	8
MFE.10A	10

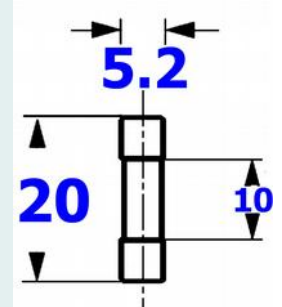

Miniature Fuse 5 x 20mm, Quick-Acting (F), 250V

Rated voltage: 250VAC

Design: quick-acting (F)

Size: 5 x 20mm

Breaking capacity: 35A @ 250VAC

Ambient temperature: -55°C to + 125°C



Order no	Current (A)
MFFA.032	32m
MFF.A05	50m
MFF.A063	63m
MFF.A08	80m
MFF.A1	100m
MFF.A 125	125m
MFFA 16	160m
MFF.A2	200m
MFF.A25	250m
MFF.A315	315m
MFF.A4	400m
MFF.A5	500m
MFF.A63	630m
MFF.A8	800m

Order no	Current (A)
MFF.1A	1
MFF1A25	1.25
MFF.1A6	1.6
MFF.2A	2
MFF.2A5	2.5
MFF.3A 15	3.15
MFF.4A	4
MFF.5A	5
MFF.6A3	6.3
MFF.8A	8
MFF.10A	10

Miniature Fuse 5 x 20mm, Medium-Time-Lag (M), 250V

Rated voltage: 250VAC

Design: medium-time-lag (M)

Size: 5 x 20mm

Breaking capacity: 80A @ 250VAC / 80A @ 125VDC

Ambient temperature: -40°C to +85°C



Order no	Current (A)
MFM.A02	20m
MFM.A032	32m
MFM.A05	50m
MFM.A063	63m
MFM.A08	80m
MFM.A1	100m
MFM.A 125	125m
MFM.A 16	160m
MFM.A2	200m
MFM.A25	250m
MFM.A315	315m
MFM.A4	400m
MFM.A5	500m
MFM.A63	630m
MFM.A8	800m

Order no	Current (A)
MFM.1A	1
MFM.1A25	1.25
MFM.1A6	1.6
MFM.2A	2
MFM.2A5	2.5
MFM.3A 15	3.15
MFM.4A	4
MFM.5A	5
MFM.6A3	6.3
MFM.8A	8
MFM.10A	10
MFM.12A5	12.5
MFM.16A	16

Miniature Fuse 5 x 20mm, Time-Lag (T), 250V

Rated voltage: 250VAC

Design: time-lag T

Size: 5 x 20mm

Breaking capacity: 35A @ 250VAC

Ambient temperature: -55°C to +125°C



Order no	Current (A)
MFT.A032	32m
MFT.A05	50m
MFT.A063	63m
MFT.A08	80m
MFT.A1	100m
MFT.A 125	125m
MFT.A 16	160m
MFT.A2	200m
MFT.A25	250m
MFT.A315	315m
MFT.A4	400m
MFT.A5	500m
MFT.A63	630m
MFT.A8	800m

Order no	Current (A)
MFT.1A	1
MFT.1A25	1.25
MFT.1A6	1.6
MFT.2A	2
MFT.2A5	2.5
MFT.3A 15	3.15
MFT.4A	4
MFT.5A	5
MFT.6A3	6.3
MFT.8A	8
MFT.10A	10
MFT.12A5	12.5
MFT.16A	16

Miniature Fuse 5 x 20mm, Time-Lag (T), 250V

Ausschaltvermögen: 1500A @ 250VAC, cosΦ = 0.7 - 0.8

Order no	Current (A)
MFT.SPT.A63	630m



Fuse Holder for Fuses 5x20mm



Order no	Max Current	Max Voltage	Make	Description
MFC	6.3A	63V	Schurter	Fuse holder inline
MFI	6.3A	250V	Schurter	Clip tinned
MFI.90	6.3A	250V	Schurter	Clip tinned
MFS	6.3A	250V	Schurter	Panel-mounting fuse holder
MFL	8A	250V		Push-on caps
MFO	10A	250V	Schurter	Shock-save fuse holder
MFO.BS	10A	250V	Schurter	Shock-save fuse holder
MFO.BG	10A	250V	Schurter	Shock-save fuse holder
MFH.520S	10A	250V	Schurter	Fuse holder open design
MFG.520S	10A	250V	Schurter	Fuse holder open design
MFG.520H			Schurter	Cover for holder MFG.520S
MFG.520OGN	10A	250V	Schurter	Fuse holder open design OGN
MFP.AGH	10A	250V	Schurter	Shock-save fuse holder horizontal
MFP.V	10A	250V	Schurter	Fuse holder vertical
MFP.AGV	10A	250V	Schurter	Shock-save fuse holder vertical
MFP.H	10A	400V	Schurter	Fuse holder horizontal
MFG.G				PCB fuse holder 5x20mm + 6.3x32mm
MFH.G				Solder fuse holder 5x20mm + 6.3x32mm

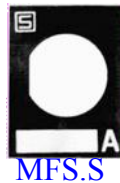
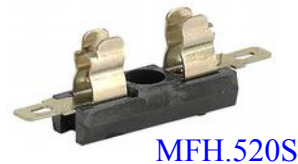
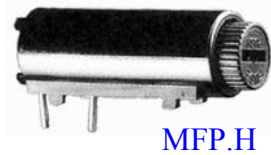

Order no	Make	Description	
MFS.S	Schurter	Marking plate	Suitable:
MFS.F	Schurter	Flange for fuse holder	MFN, MFO, MFO.BG,
MFS.VS	Schurter	Anti rotation washer	MFO.BS, MFS

Fuse Holder for Fuses 6.3x32mm



Order no	Max Current	Max Voltage	Make	Description
MFN	6.3A/10A	250V/500V	Schurter	Fuse holder panel mount
MFL.63	8A	250V		Push on caps
MFK	10A	250V	Schurter	Clip tinned
MFG.632S	10A	250V	Schurter	Fuse holder open design PCB
MFH.632S	16A	250V	Schurter	Fuse holder open design solder/screw
MFG.G				PCB fuse holder 5x20mm + 6.3x32mm
MFH.G				Solder fuse holder 5x20mm + 6.3x32mm



Miniature Fuse 6.3 x 32mm, Super-Quick-Acting (FF), 250V

Rated voltage: 250VAC
 Design: super-quick-acting (FF)
 Size: 6.3 x 32mm
 Breaking capacity: 1500A @ 250VAC (cos phi = 0.7 - 0.8)
 Ambient temperature: -40°C to +85°C



Order no	Current (A)
MGS.1A6	1.6
MGS.2A	2
MGS.2A5	2.5
MGS.3A15	3.15
MGS.4A	4
MGS.5A	5
MGS.6A3	6.3
MGS.8A	8
MGS.10A	10
MGS.12A5	12.5
MGS.16A	16

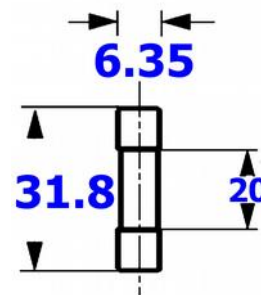

Miniature Fuse 6.3 x 32mm, Quick-Acting (F), 250V

Rated voltage: 250VAC
 Design: quick-acting (F)
 Size: 6.3 x 32mm
 Breaking capacity: 35A @ 250VAC (cos phi = 1)
 Ambient temperature: -40°C to +85°C



Order no	Current (A)
MGF.A032	32m
MGF.A05	50m
MGF.A063	63m
MGF.A08	80m
MGF.A1	100m
MGF.A125	125m
MGF.A16	160m
MGF.A2	200m
MGF.A25	250mA
MGF.A315	315m
MGF.A4	400m
MGF.A5	500m
MGF.A63	630m
MGF.A8	800m

Order no	Current (A)
MGF.1A	1
MGF.1A25	1.25
MGF.1A6	1.6
MGF.2A	2
MGF.2A5	2.5
MGF.3A15	3.15
MGF.4A	4
MGF.5A	5
MGF.6A3	6.3
MGF.8A	8
MGF.10A	10
MGF.12A5	12.5
MGF.16A	16
MGF.20A	20

Miniature Fuse 6.3 x 32mm, Medium-Time-Lag (M), 250V

Rated voltage: 250VAC
 Design: medium-time-lag M
 Size: 6.3 x 32mm
 Ambient temperature: -40°C to +85°C



Order no	Current (A)
MGM.1A	1

Miniature Fuse 6.3 x 32mm, Time-Lag (M), 250V

Rated voltage: 250VAC
 Design: time-lag T
 Size: 6.3 x 32mm
 Breaking capacity: 10 In @ 250VAC (cos phi = 1)
 Ambient temperature: -40°C to +85°C



Order no	Current (A)
MGT.A032	32m
MGT.A05	50m
MGT.A063	63m
MGT.A08	80m
MGT.A1	100m
MGT.A125	125m
MGT.A16	160m
MGT.A2	200m
MGT.A25	250m
MGT.A315	315m
MGT.A4	400m
MGT.A5	500m
MGT.A63	630m
MGT.A8	800m

Order no	Current (A)
MGT.1A	1
MGT.1A25	1.25
MGT.1A6	1.6
MGT.2A	2
MGT.2A5	2.5
MGT.3A15	3.15
MGT.4A	4
MGT.5A	5
MGT.6A3	6.3
MGT.8A	8
MGT.10A	10
MGT.12A5	12.5
MGT.16A	16
MGT.20A	20
MGT.25A	25

Radial Leaded Resettable Fuse Schurter Typ PFRA

Applications:
 - computer & peripherals
 - general electronics
 - automotive applications

Electrical characteristics current hold at 23°C
 Rated voltage max: 60VDC
 Rated current max: 40A
 Description: THT standard type
 Ambient temperature: -40°C to 85°C



Order no	Current hold	Schurter Type
RAF.010	0.1A	PFRA.010
RAF.030	0.3A	PFRA.030
RAF.050	0.5A	PFRA.050
RAF.065	0.65A	PFRA.065
RAF.090	0.9A	PFRA.090
RAF.110	1.1A	PFRA.110
RAF.160	1.6A	PFRA.160
RAF.185	1.85A	PFRA.185

Pico Fuse Axial Fast Acting (F) (Picofuse)

Rated voltage: 125V / 32V
 Design: fast acting (F) axial
 RoHS compliant: yes

Make Littelfuse
 Series HF 251 (MFU.062 – MFU.15A)
 Series 275 (MFU.20A – MFU.30A)



Order no	Rated current	Rated voltage	Interrupting ratings
MFU.A062	62mA	125V	50A/125VAC
MFU.A125	125mA	125V	50A/125VAC
MFU.A250	250mA	125V	50A/125VAC
MFU.A375	375mA	125V	50A/125VAC
MFU.A500	500mA	125V	50A/125VAC
MFU.A750	750mA	125V	50A/125VAC
MFU.1A	1A	125V	50A/125VAC
MFU.1A5	1.5A	125V	50A/125VAC
MFU.2A	2A	125V	50A/125VAC
MFU.2A5	2.5A	125V	50A/125VAC
MFU.3A	3A	125V	50A/125VAC
MFU.3A5	3.5A	125V	50A/125VAC
MFU.4A	4A	125V	50A/125VAC
MFU.5A	5A	125V	50A/125VAC
MFU.7A	7A	125V	50A/125VAC
MFU.10A	10A	125V	50A/125VAC
MFU.12A	12A	32V	50A/32VAC
MFU.15A	15A	32V	50A/32VAC
MFU.20A	20A	32V	50A/32VAC
MFU.25A	25A	32V	50A/32VAC
MFU.30A	30A	32V	50A/32VAC

Subminiature Fuse Quick Acting (F) (Microfuse)

- Directly solderable on printed circuit boards
 - Low breaking capacity

Rated voltage: 250VAC
 Design: quick acting (F)
 Size: 8.5 x 8.5mm
 Pitch: 5.08mm
 Ambient temperature: -55°C to 125°C
 RoHS compliant: yes



Order no	Rated current	Voltage drop
MFW.A050F	50mA	850mV
MFW.A063F	63mA	750mV
MFW.A080F	80mA	650mV
MFW.A100F	100mA	600mV
MFW.A125F	125mA	550mV
MFW.A160F	160mA	500mV
MFW.A200F	200mA	480mV
MFW.A250F	250mA	440mV
MFW.A315F	315mA	400mV
MFW.A400F	400mA	370mV
MFW.A500F	500mA	350mV
MFW.A630F	630mA	320mV
MFW.A800F	800mA	300mV
MFW.1AF	1A	280mV
MFW.1A25F	1.25A	280mV
MFW.1A6F	1.6A	250mV
MFW.2AF	2A	240mV
MFW.2A5F	2.5A	200mV
MFW.3A15F	3.15A	180mV
MFW.4AF	4A	160mV
MFW.5AF	5A	150mV

Order no	Rated current	Voltage drop
MFW.A063T	63mA	480mV
MFW.A080T	80mA	400mV
MFW.A100T	100mA	350mV
MFW.A125T	125mA	300mV
MFW.A160T	160mA	280mV
MFW.A200T	200mA	260mV
MFW.A250T	250mA	240mV
MFW.A315T	315mA	220mV
MFW.A400T	400mA	200mV
MFW.A500T	500mA	190mV
MFW.A630T	630mA	180mV
MFW.A800T	800mA	160mV
MFW.1AT	1A	140mV
MFW.1A25T	1.25A	130mV
MFW.1A6T	1.6A	120mV
MFW.2AT	2A	100mV
MFW.2A5T	2.5A	100mV
MFW.3A15T	3.15A	100mV
MFW.4AT	4A	100mV
MFW.5AT	5A	-
MFW.6A3T	6.3A	-



Subminiature Fuse Time-Lag (T) (Microfuse)

- Directly solderable on printed circuit boards
 - Low breaking capacity

Rated voltage: 250VAC
 Design: time-lag (T)
 Size: 8.5 x 8.5mm
 Pitch: 5.08mm
 Ambient temperature: -55°C to 125°C
 RoHS compliant: yes

Fuse Holder for the above Microfuses

Fuseholder to MSF250; MST250; MSTU250; MSU250; MXT250 (Schurter fuses)
 Through hole mounting

Rated voltage: 250VAC/DC
 Rated current: 6.3A
 Fuse-Link: Microfuse 250V



Order no	Description
MFW.H	PCB fuse holder

Thermal Cut-Off



Tolerance: +0°C/-10°C (IEC 691)
 Rated current max: 1A
 Rated voltage: 250VAC
 Ambient temperature max: +200°C



Order no	Holding temperature	Rated functioning temperature	Current max
MGW.1.102	76°C	102°C	1A
MGW.1.115	89°C	115°C	1A
MGW.1.130	102°C	130°C	1A
MGW.1.133	108°C	133°C	1A



Tolerance: +0°C/-10°C (IEC 691)
 Rated current max: 3A
 Rated voltage: 250VAC
 Ambient temperature max: +200°C



Order no	Holding temperature	Rated functioning temperature	Current max
MGW.3.102	76°C	102°C	3A
MGW.3.115	89°C	115°C	3A
MGW.3.130	102°C	130°C	3A
MGW.3.133	108°C	133°C	3A



Thermal Fuse, Thermal Cut-Offs, Thermal Links Axial

Rated current: 10A
 Rated voltage: 230V/380V



Order no	Type		Schuter MTS-Series	Elmwood no	Holding temperature	Opens at	
MGX.4136	4136		1334.0501		55°C	60°C	
MGX.4146	4146		1334.0502		59°C	66°C	
MGX.4158	4158	G4A XXX 72C	1334.0503	D070-002	65°C	72°C	
MGX.4168	4168	G4A XXX 77C	1334.0504	D076-002	70°C	77°C	
MGX.4178	4178	G4A XXX 84C	1334.0505	D081-002	77°C	84°C	
MGX.4191	4191		1334.0506	D085-002	86°C	91°C	
MGX.4194	4194	G4A XXX 93C	1334.0523	D090-002	88°C	93°C	
MGX.4204	4204	G4A XXX 98C	1334.0507		94°C	98°C	
MGX.4208	4208		1334.0507	D098-002	94°C	100°C	
MGX.4218	4218		1334.0509		100°C	104°C	
MGX.4227	4227	G4A XXX 110C	1334.0510	D108-002	106°C	109°C	Heisswasser/Boiler
MGX.4239	4239	G4A XXX 117C	1334.0511	D115-002	112°C	117°C	
MGX.4244	4244		1334.0512		114°C	121°C	
MGX.4257	4257	G4A XXX 128C	1334.0513	D125-002	122°C	128°C	Moulinex
MGX.4283	4283	G4A XXX 144C	1334.0514	D139-002	133°C	141°C	Philips
MGX.4298	4298		1334.0515		143°C	150°C	
MGX.4300	4300	G4A XXX 152C	1334.0516	D149-002	144°C	152°C	
MGX.4333	4333	G4A XXX 167C	1334.0517	D167-002	166°C	171°C	Moulinex
MGX.4358	4358		1334.0518	D181-002	176°C	184°C	
MGX.4377	4377	G4A XXX 192C	1334.0519		182°C	194°C	AEG
MGX.4415	4415	G4A XXX 216C	1334.0520	D213-002	202°C	216°C	Krups
MGX.4438	4438	G4A XXX 228C	1334.0521	D226-002	204°C	228°C	Saeco
MGX.4468	4468	G4A XXX 240C	1334.0522	D242-002	204°C	240°C	Bosch

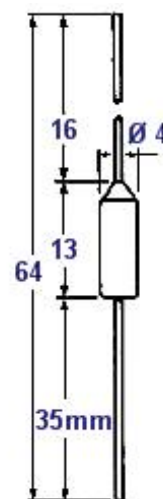

Thermostat, Thermal Cut-Out Fuse

Reset type: automatic (12°C to 20°C)
 Rated voltage: 230VAC
 Rated current: 10A
 Tolerance: ±5%



NC Normally Closed Thermal Fuse

Order no	opens at
MGY.40NC	40°C
MGY.50NC	50°C
MGY.60NC	60°C
MGY.70NC	70°C
MGY.80NC	80°C
MGY.90NC	90°C
MGY.100NC	100°C
MGY.120NC	120°C
MGY.150NC	150°C

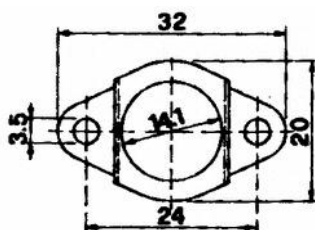

NO Normally Open Thermal Fuse

Order no	closes at
MGY.40NO	40°C
MGY.50NO	50°C
MGY.60NO	60°C
MGY.70NO	70°C
MGY.80NO	80°C
MGY.90NO	90°C
MGY.100NO	100°C



Midget Fuse, Fast-Acting, 10.3 x 38mm, 1000VDC, Photovoltaic, gPV

String fuse for photovoltaic systems

Rated voltage: 1000 VDC
 Breaking capacity: 20 kA
 Characteristic: gPV
 Ambient temperature: -40°C to 85°C
 Dimensions: 10.3 x 38mm

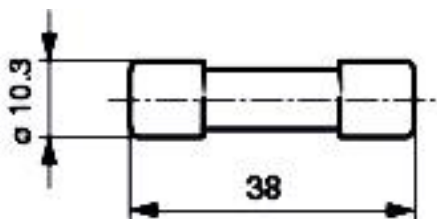

Order no	Rated current	Power dissipation	Schurter
MGA.ASO.1AF	1A	602mW	0090.0001
MGA.ASO.2AF	2A	1586mW	0090.0002
MGA.ASO.3AF	3A	1504mW	0090.0003
MGA.ASO.4AF	4A	1491mW	0090.0004
MGA.ASO.5AF	5A	1465mW	0090.0005
MGA.ASO.6AF	6A	1348mW	0090.0006
MGA.ASO.8AF	8A	1610mW	0090.0008
MGA.ASO.10AF	10A	1760mW	0090.0010
MGA.ASO.12AF	12A	1965mW	0090.0012
MGA.ASO.15AF	15A	1914mW	0090.0014
MGA.ASO.20AF	20A	2810mW	0090.0020
MGA.ASO.25AF	25A	2981mW	0090.0025
MGA.ASO.30AF	30A	3923mW	0090.0030

Suitable Fuse Holder ASO 10,3x38mm

35mm DIL-rail mounting



Order no	Schurter
MGA.ASO.FS1D	0091.0001



Diazed Fuse

Diazed fuse DTII 10A 500V
 Rated voltage: 500V
 Design: time-lag



Order no	Rated current
MFV.10A	10A
MFV.16A	16A
MFV.20A	20A
MFV.25A	25A

Circuit Breaker for Equipment (CBE) Schurter T11-211R

The T11 series of circuit breakers for equipment is a line of small, single pole push to reset, overload protective devices. The trip mechanism is of the superior «latch type». A high contact force can be maintained until the unit trips. This prevents electrical «noise» due to contact bounce and reduces the risk of contact welding which may occur with spring type mechanism.

The overload sensing is done with the aid of a thermal bimetal which has the advantage of being immune to high inrush currents and line transients. All T11-units are «positively trip-free». The contacts will open and will remain open during an overload. Contacts cannot be held in the closed position and they will not close automatically even if the closing command is maintained.

The T11 is specifically designed to protect equipment, wiring, transformers, power supplies, motors and sub-assemblies, such as printed circuit boards. For non-PCB mounting the T11 is connected to wiring with the popular quick connect terminals. Rated currents can be specified from 0,05 A to 16 A. All models are internationally approved.

Rated voltage: 240VAC/48VDC
 Short circuit capacity (I_{cn}) at 240VAC: 8 x I
 Mounting: threaded neck 3/8–27UNS–2A 6mm
 Terminal: quick connect terminals 6.3 x 0.8mm IEC 61210
 Actuation: reset type
 Construction: Setting indication on reset button
 Ambient temperature: -5°C to +60°C
 Make



Order no	Rated current	Schurter
SBT.T11.02	0.2A	T11-211R-0,2
SBT.T11.05	0.5A	T11-211R-0,5
SBT.T11.08	0.8A	T11-211R-0,8
SBT.T11.10	1A	T11-211R-1,0
SBT.T11.15	1.5A	T11-211R-1,5
SBT.T11.20	2A	T11-211R-2,0
SBT.T11.25	2.5A	T11-211R-2,5
SBT.T11.30	3A	T11-211R-3,0
SBT.T11.40	4A	T11-211R-4,0
SBT.T11.50	5A	T11-211R-5,0
SBT.T11.60	6A	T11-211R-6,0
SBT.T11.80	8A	T11-211R-8,0

Circuit Breaker for Equipment (CBE) 250VAC/28VDC Schurter T12-211R

The well proven mechanism is designed to open the contacts in the event of a current flow in excess of the time/current characteristic of the device. A bimetal strip is heated by the overcurrent and deflects, thereby releasing the latch mechanism. The contacts will open even if the reset button is manually held in the closed position. This is known as the positively trip-free feature. The contacts open and close with a snap action and the tripped state is clearly shown by the increased projection of the reset button. After operation, the mechanism will not latch closed until the manual reset button is fully depressed and then released.

Rated voltage: 250VAC/28VDC
 Short circuit capacity (I_{cn}) VDE0660 @ 240VAC: 8 x I
 Short circuit capacity (I_{cn}) VDE0660 @ 28VAC/DC: 400A
 Terminal: 6.3x0.8mm quick connect terminals
 Make Schurter Type T12-211R
 Equivalent to E-T-A Type 2-5700-IG1-P10



Order no	Rated current	Schurter
SBT.A5	0.5A	T12-211R-0,5
SBT.A8	0.8A	T12-211R-0,8
SBT.1A	1A	T12-211R-1,0
SBT.2A	2A	T12-211R-2,0
SBT.3A	3A	T12-211R-3,0
SBT.4A	4A	T12-211R-4,0
SBT.5A	5A	T12-211R-5,0
SBT.6A	6A	T12-211R-6,0
SBT.8A	8A	T12-211R-8,0
SBT.10A	10A	T12-211R-10
SBT.12A	12A	T12-211R-12
SBT.15A	15A	T12-211R-15
SBT.20A	20A	T12-211R-20

Thermal Overcurrent Circuit Breaker 250VAC/28VDC E-T-A 1110-F..

Single pole switch/thermal circuit breaker (M-type TO CBE to EN 60934) with tease-free, trip-free, snap action mechanism. Designed for snap-in panel mounting utilising keyed round hole or industry standard fuse-holder cut-out dimensions. Featuring an ergonomically styled two colour actuator with indicator band clearly showing the tripped/OFF position.

Rated voltage: 250VAC/28VDC
 Interrupting capacity (I_{cn}) VDE0660 @ 250VAC: 8 x I
 Interrupting capacity (I_{cn}) VDE0660 @ 28VDC: 10 x I
 Thickness panel: 0.8mm to 1.6mm
 Blade terminals: 6.3x0.8mm
 Make: E-T-A (Type: 1110-F)

While stock lasts



Order no	Rated current	ETA
SBS.A1	0.1A	1110-F312-P1M1-0,1A
SBS.A2	0.2A	1110-F312-P1M1-0,2A
SBS.A3	0.3A	1110-F312-P1M1-0,3A
SBS.A4	0.4A	1110-F312-P1M1-0,4A
SBS.A5	0.5A	1110-F112-P1M1-0,5A
SBS.A7	0.7A	1110-F312-P1M1-0,7A
SBS.A8	0.8A	1110-F112-P1M1-0,8A
SBS.1A	1A	1110-F112-P1M1-1,0A
SBS.1A2	1.2A	1110-F112-P1M1-1,2A
SBS.1A5	1.5A	1110-F112-P1M1-1,5A
SBS.1A8	1.8A	1110-F112-P1M1-1,8A
SBS.2A	2A	1110-F312-P1M1-2,0A

Subject to alterations and errors.
 Pictures are a guide only actual product may vary.



Order no	Rated current (A)	Voltage drop	Housing colour
MFD.1A	1	175mV	black
MFD.2A	2	175mV	grey
MFD.3A	3	175mV	purple
MFD.4A	4	175mV	pink
MFD.5A	5	175mV	light brown
MFD.7.5A	7.5	150mV	brown
MFD.10A	10	125mV	red
MFD.15A	15	125mV	light blue
MFD.20A	20	125mV	yellow
MFD.25A	25	100mV	white
MFD.30A	30	100mV	light green
MFD.40	40		orange

ATO/FKS Style Blade Fuse 32V 6.3 x 0.8mm

Rated voltage: 32V
 Terminals: blade terminals 6.3 x 0.8mm
 Temperature max: +230°C
 Insulating body: out of thermoplastic (UL 94-V0, heat-resistant)

Blade Fuse Holder for FKS / ATO Fuses with Screw Connection

With screw connection for 2, 3 or 4 elements
 Connection cross-section: 4mm²
 Max operating voltage (UB): 32V
 Max working load (IB): 30A



Order no	Article for	L
MFD.HS2	2 elements	32mm
MFD.HS3	3 elements	38mm
MFD.HS4	4 elements	44mm

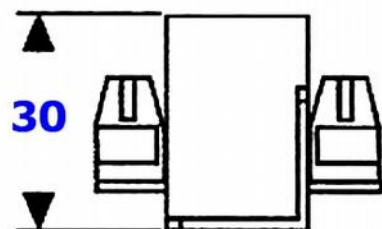
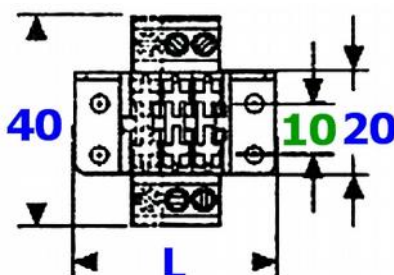

FK-Inlineholder for Fuse Links up to 32V

Insulation-displacement-connection, copper-alloy, tinned

Connection cross-section: 0.8mm² to 2.5mm²
 Max operating voltage (UB): 32V
 Max working load (IB): 20A



Order no	Description
MFD.HK	Fuse holder complete

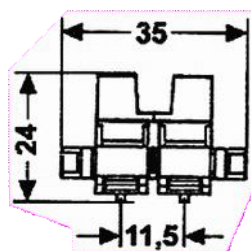

Blade Fuseholder, Stackable Block Fuseholder

Leaf spring connector systems, crimp contacts, copper alloy, tinned
 Attachable in X- and Y-direction.

Connection cross-section: 1.5mm² to 2.5mm²
 Max operating voltage (UB): 36V
 Max working load (IB): 30A

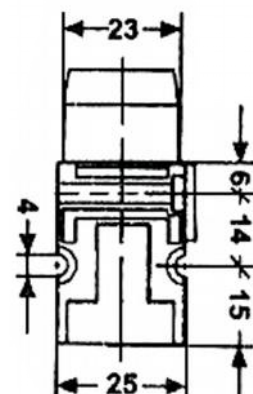

Order no	Description
MFD.HD	Fuse holder complete
MFD.K	DFK-contact



Fuse Block Accommodates 4, 6 or 8 ATO/FKS Blade Fuses



Order no	Accommodates	Hole spacing	MTA no
MFD.HG4	4 blade fuses	65mm	0100610
MFD.HG6	6 blade fuses	85mm	0100600
MFD.HG8	8 blade fuses	105mm	0100590



Littelfuse Bolt-Down Fuses L498 Midi 41x12mm

The MIDI® Fuse offers a bolt-on space saving fuse for high current wiring protection and provides time delay characteristics with “Diffusion Pill Technology”.

Rated voltage: 32V
 Dimensions: 41x12mm
 Hole spacing: 30mm
 RoHS compliant: yes



Order no	Rated current	Littelfuse
MGG.MI30A	30A	498030 MIDI-30
MGG.MI50A	50A	498050 MIDI-50
MGG.MI60A	60A	498060 MIDI-60
MGG.MI70A	70A	498070 MIDI-70

Littelfuse Bolt-Down Fuse L298 Mega 69x19mm

The MEGA® Fuse is designed for high current circuit protection up to 500A with “Diffusion Pill Technology.” The MEGA® Fuse also provides time delay characteristics.

Rated voltage: 32V
 Dimensions: 68.58 x 19.05mm (2.7” x 0.75”)
 Hole spacing: 50.8mm (2”)
 RoHS compliant: yes



Order no	Rated current	Littelfuse
MGG.GA100	100A	298100 MEGA-100



Fuse Strip with Housing for Battery-Powered Vehicles Rated 80V

Housed fuse strips for battery-powered vehicles. With window for visual inspection of melting element.

Rated voltage: 80V
 Rated current: 80A
 Dimensions: 82 x 20mm (11mm)
 Fits: 2x M10 screws
 Distance between holes: 60mm
 RoHS compliant: yes



Order no	Rated current	Littelfuse
MGG.80A	80A	157.5701.5801

Torpedo Style Fuse Rated 36V

Rated voltage: 36V
 Voltage drop (UD): 100mV
 Insulator: 5A = Thermoplast, 8 – 16A = ceramic



Order no	Rated current (A)	Housing colour
MFA.5A	5	yellow
MFA.8A	8	white
MFA.16A	16	red
MFA.25A	25	blue



ATS In-line Fuse Holder for Torpedo Style Fuse Rated 36V

Rated voltage (UB): 36V
 Rated current (IB): 20A



Oder no	Description
MFA.H	Fuse holder complete